











## 7. Listes des pièces détachées

### 7.1 Pour hauteur de levage 100mm

Item No.	Description	Qty
01	Dust-proof Cover	4
02	Cushion	2
03	Lock nut M10	2
04	Woven Stripe	1
05	Screw M10X70	2
06A	Lifting Frame	1
07	Cargo Lashings	1
08A	Supporting Frame	1
09	Nylon Washer	2
10	Cylindrical Spring Pin $\varnothing 6 \times 30$	2
11	Handle Assy.	2
12	Hand Tube	1
13	Split Ring 9	2
14A	Hydraulic Jack	1
15	Screw M6X20	2
16A	Screw M6X12	1
17A	Lock nut M6	2
18	Dust-proof Ring	2
19	Bearing 8204	2
20A	Supporting Rod	2
21	Screw M12X85	2
22	Washer 12	2
23	Spring washer	2
24	Nut M12	2
25	Bushing	4
26	Bushing	2
27	Bearing	2

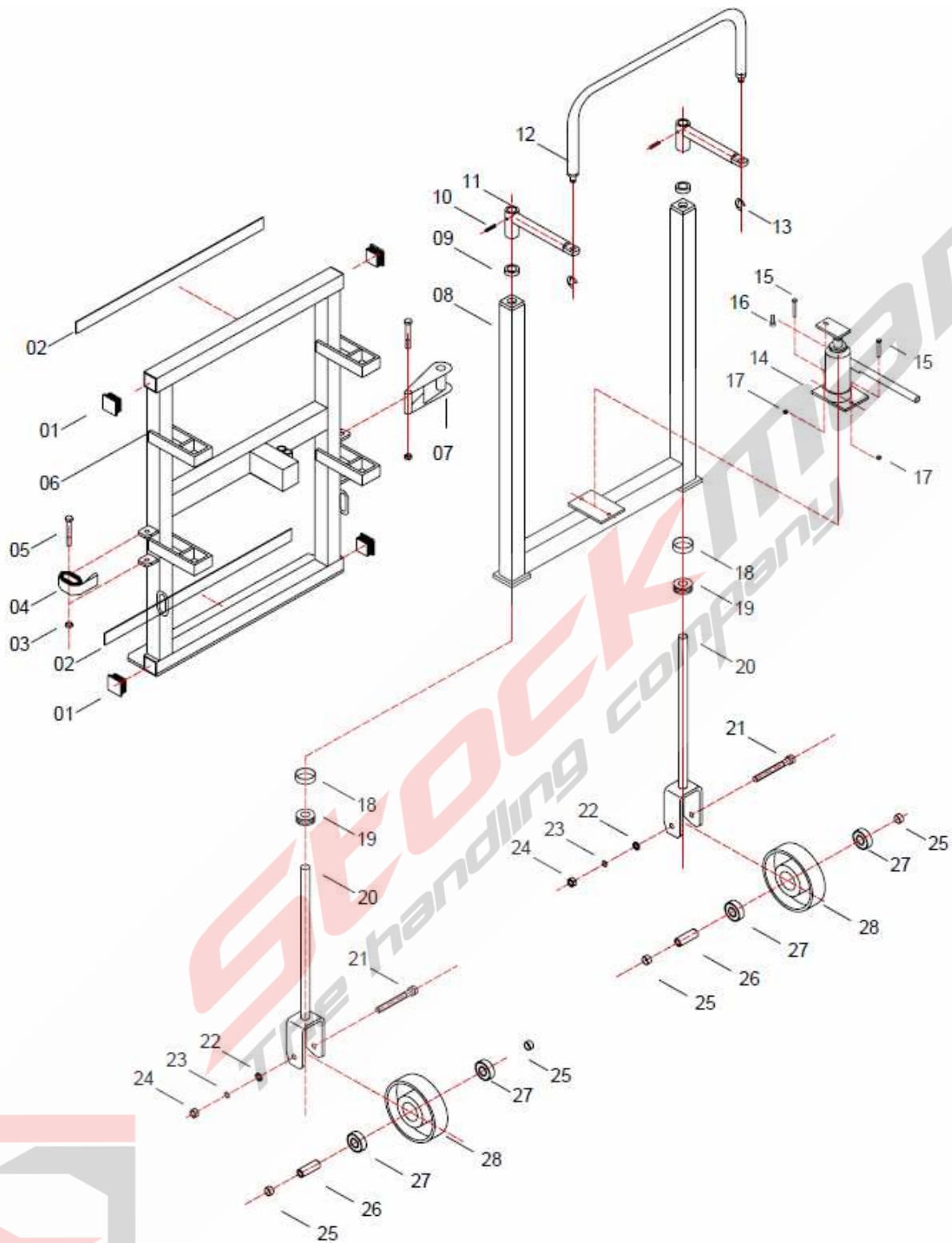

## 7.2 Pour hauteur de levage 250mm

Item No.	Description	Qty
01	Dust-proof Cover	4
02	Cushion	2
03	Lock nut M10	2
04	Woven Stripe	1
05	Screw M10×70	2
06B	Lifting Frame	1
07	Cargo Lashings	1
08B	Supporting Frame	1
09	Nylon Washer	2
10	Cylindrical Spring Pin $\hat{O}6 \times 30$	2
11	Handle Assy.	2
12	Hand Tube	1
13	Split Ring 9	2
14B	Hydraulic Jack	1
15	Screw M6×20	2
16B	Split Ring 8	2
17B	Pin	1
18	Dust-proof Ring	2
19	Bearing 8204	2
20B	Supporting Rod	2
21	Screw M12×85	2
22	Washer 12	2
23	Spring washer 12	2
24	Nut M12	2
25	Bushing	4
26	Bushing	2
27	Bearing	2
28	Wheel	2





